

CITY OF ELGIN, OREGON RESOLUTION 1366 (2015)
SPECIAL CITY ALLOTMENT GRANT

WHEREAS: Under the provisions of ORS 366.800 and 366.805, there has been withdrawn from state highway funds appropriated for allocation to the several cities of the State of Oregon and the sum of Five Hundred Thousand and No/100 (\$500,000.00) Dollars; AND

WHEREAS: In addition there has been withdrawn from monies available to the Department of Transportation from the State Highway Fund the sum of Five Hundred Thousand and No/100 (\$500,000.00) Dollars; AND

WHEREAS: As provided in ORS 366.805, said sums have been set up in a separate account to be administered by the Oregon Transportation Commission and to be allotted each year by said commission to be spent, within cities of 5,000 or fewer persons, upon streets not part of the state highway system that are inadequate for the capacity they serve, or are in a condition detrimental to safety.

NOW THEREFORE BE IT RESOLVED THAT: The City of Elgin is an incorporated city of the State of Oregon and has a population of less than 5,000 as given by the latest official federal census; AND

NOW THEREFORE BE IT RESOLVED THAT: The following streets of said city, North 9th Street, meet the conditions required in ORS 366.805.

NOW THEREFORE BE IT RESOLVED THAT: The members of the City Council, in regular session assembled, do hereby find, declare, and resolve:

1. That the aforementioned named streets of Elgin are inadequate for the capacity they serve or are in a condition detrimental to safety.
2. That said streets of said City are in need of repair, reconstruction, or other major improvement.
3. That said streets are not part of the state highway system, and are under the jurisdiction and control of the City.
4. That the Oregon Transportation Commission hereby is respectfully requested to consider and declare said streets as qualified for reconstruction, repair, or other improvements out of funds allocated and made available by and through the said \$1,000,000.00 appropriation of revenues which is to be administered and spent by the Transportation Commission.
5. That the City of Elgin does hereby offer to Transportation Commission and does hereby pledge complete cooperation and assistance to the end, that said City may share and participate in the use and benefit of said special fund and appropriation; and therefore does designate Dan Larman, Public Works Director and John Garlitz of JUB Engineering, City Engineer and Brock Eckstein, City Administrator as the official representatives of the City in all negotiations resulting from this request.

PASSED AND ADOPTED this 14th day of July, 2015.

There is attached hereto and made a part of hereof, a copy of the proposed project containing City of Elgin maps as well as the scope of the work to be completed.

With 7 Ayes, 0 Nays, 0 Abstentions, 0 Absent

Signed:

Allan P. Duffy
Allan Duffy, Mayor

Council Votes as Follows:

Allan Duffy, Mayor Aye

Rocky Burgess, Councilor Aye

Teresa Shaffer, Councilor Aye

Brent Linville, Councilor Aye

Michelle Miles, Councilor Aye

Kathy Warren, Councilor Aye

Jeremy Richards, Councilor Aye

State of Oregon

County of Union

I hereby certify that the foregoing resolution was passed and approved by the City Council of the City of Elgin Oregon at a regular or special meeting of said Council, held on the 14th day of July 2015, and the above copy is a true and correct copy of the original document and of the whole thereof.

Certified this 14 day of July 20 15.

Brock Eckstein

Notary Name Here, Notary Public

My Commission Expires June 7, 2019

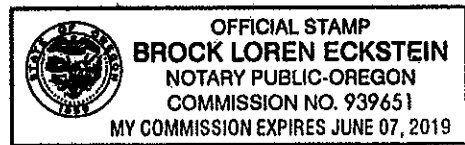

SPECIAL CITY ALLOTMENT (SCA) APPLICATION

CITY OF ELGIN

DATE 7-9-15

Street Name N 9TH

From GALVESTON

To HARTFORD

(Attach map showing project limits)

PROJECT DETAILS:

Project Length: 6 mi

Est. Project Cost \$: 1,300,000

Ave Daily Traffic: 250 cars

Ave Daily Truck Traffic: 9-10

PROPOSED TYPICAL X-SECTION

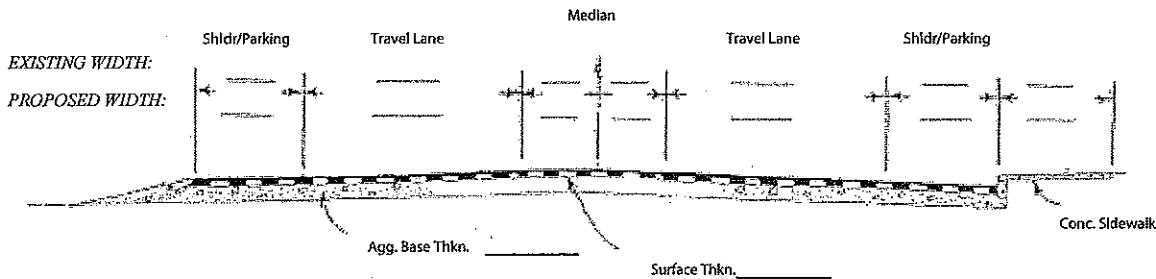

PAVEMENT:

Surface Type

Existing: CHIP SEAL
 Proposed: 3" ASPHALT
 Proposed Thkn: _____

STORM SEWER:

Existing (Y/N): YES
 Proposed (Y/N): NO
 Pipe Dia: 12"
 Pipe Length: 500'
 Adjustments: WORK 1
 Inlets #: 1
 Manholes #: 0
 Pipes #: 0

RIGHT-OF-WAY:

Existing Width: _____
 Existing Right-of-way Adequate (Y/N): Y
 Proposed Width: _____

SIDEWALKS:

Existing (Y/N): Y
 Proposed (Y/N): Lt Side: X Rt Side: X
 Proposed Length: 1000'
 Proposed Width: 5'

CURBS:

Existing (Y/N): Y
 Proposed (Y/N): Lt Side: X Rt Side: X
 Length: 1000'
 Type: 6"

BRIDGE:

Name: _____
 Br #: _____
 Length: _____
 Width: _____
 Type of Structure: _____
 Sufficiency Rating No: _____
 Name of Stream: _____

Remarks: PROJECT IS IN DESIGN PHASE
BID PHASE WILL BE 7-17-15 TO 7-31-15
CONSTRUCTION WILL BE 8-3-15 TO 11-1-15

BY: Allen R. Dufely DATE: 7/14/15
 Mayor

BY: Brenda Elms DATE: 7/14/15
 City Recorder

BY: Brenda Elms DATE: 7/14/15
 City Administrator

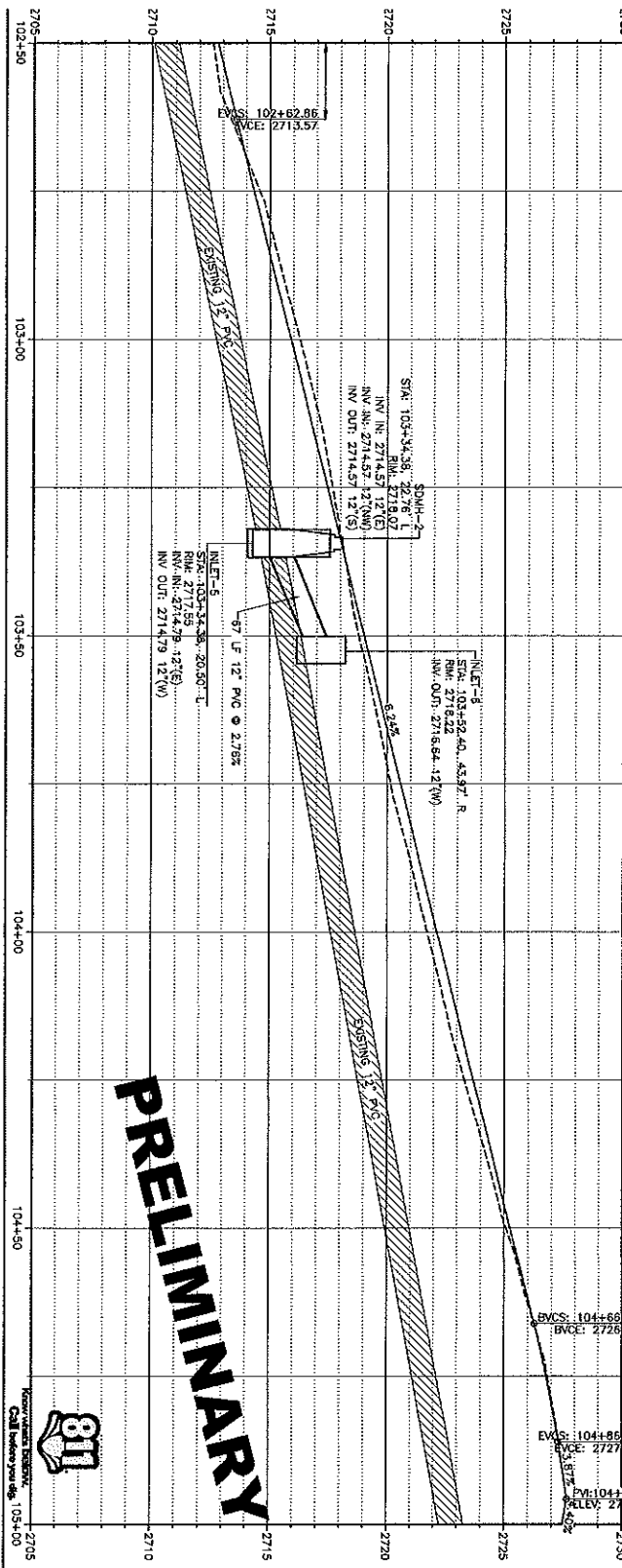
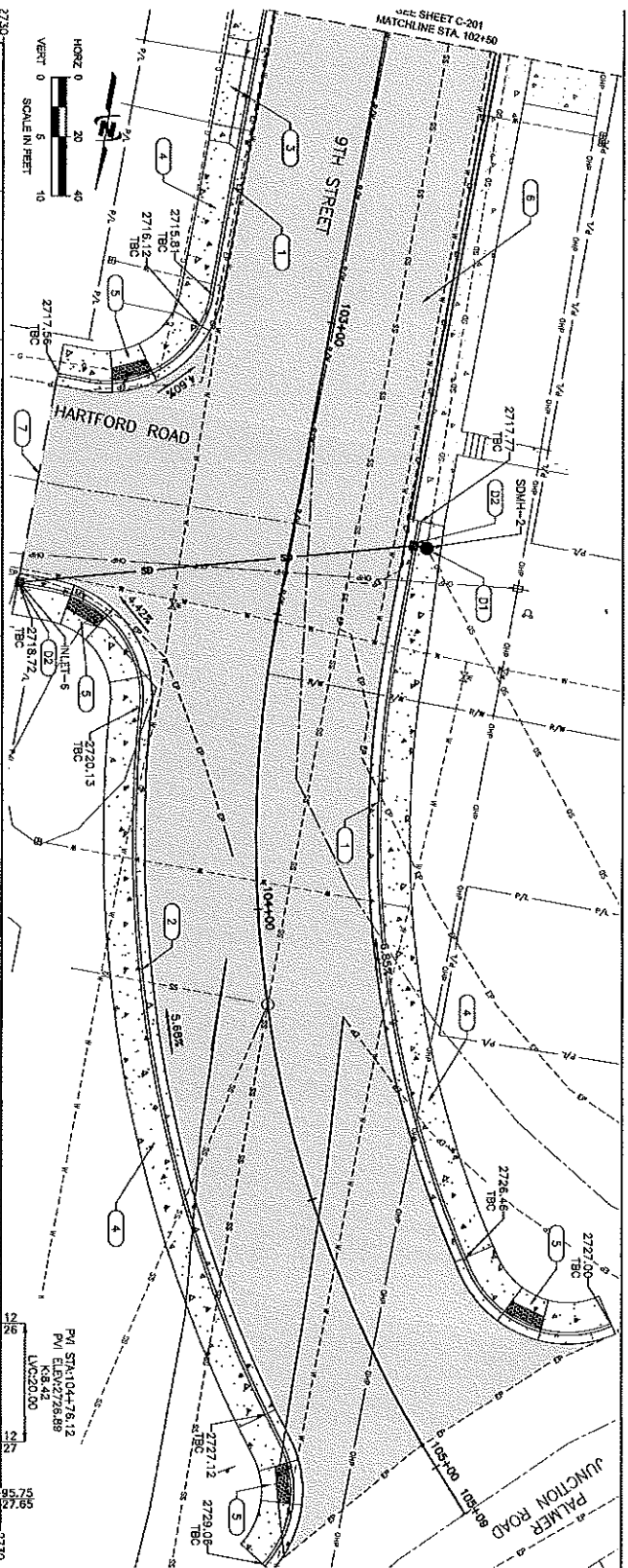

PRELIMINARY



811
Call before you dig
1-800-4-A-DAWG
1-800-452-7273
1-800-452-7272

- ROADWAY KEYED NOTES**
- 1. CONST CONCRETE CURBS, CURB AND GUTTER, 18" LF (FOR DETAILS, SEE 0007 STD DWG RD070).
 - 2. CONST CONCRETE CURBS, CURB AND GUTTER, 12" LF (FOR DETAILS, SEE 0007 STD DWG RD070).
 - 3. CONST CONCRETE DRAINWAYS, OPTION N, 90 SF (FOR DETAILS, SEE 0007 STD DWG RD075).
 - 4. CONST CONCRETE WALKS, 18" ROAD FOR DETAILS, 18" ROAD STD DWG RD020).
 - 5. CONST CONCRETE SIDEWALK RAIPIS, 4 EA (FOR DETAILS, SEE 0007 STD DWG RD075).
 - 6. CONST FULL DEPTH HMA*, SEE TYPICAL SECTION SHEET C-101, 10.5(5) SF ASPHALT PARALLEL SAW CUTTING, 32 LF.
- DRAINAGE KEYED NOTES**
- 1. CONST CONCRETE STORM SEWER MANHOLES, 3' EA (FOR DETAILS, SEE 0007 STD DWG RD035).
 - 2. CONST CONCRETE INLET TYPE G-1, 2 EA (FOR DETAILS, SEE 0007 STD DWG RD085).
 - 3. PROPOSED HOT MIX ASPHALT PAVEMENT (HMAP).
 - 4. EXISTING CONCRETE.
 - 5. PROPOSED CONCRETE.
- NOTES**
1. SEE DRAWING DM-101 AND DM-102 FOR DEMOLITION AND RELOCATIONS.
 2. ALL QUANTITIES ARE FOR THIS SHEET ONLY.

<p>9TH ST. IMPROVEMENTS: HARTFORD TO GALVESTON RD CITY OF ELGIN</p>			<p>811 Call before you dig 1-800-4-A-DAWG 1-800-452-7273 1-800-452-7272</p>								
<p>DRAINAGE AND GRADING PLAN AND PROFILE</p>			<p>REVISION</p> <table border="1"> <tr> <th>NO.</th> <th>DESCRIPTION</th> <th>DATE</th> </tr> <tr> <td> </td> <td> </td> <td> </td> </tr> </table>			NO.	DESCRIPTION	DATE			
NO.	DESCRIPTION	DATE									
<p>C-202</p>			<p>J-U-B ENGINEERS, INC. 1201 Adams Avenue La Grande, OR 97850 Phone: 541.963.7100 www.jub.com</p>								

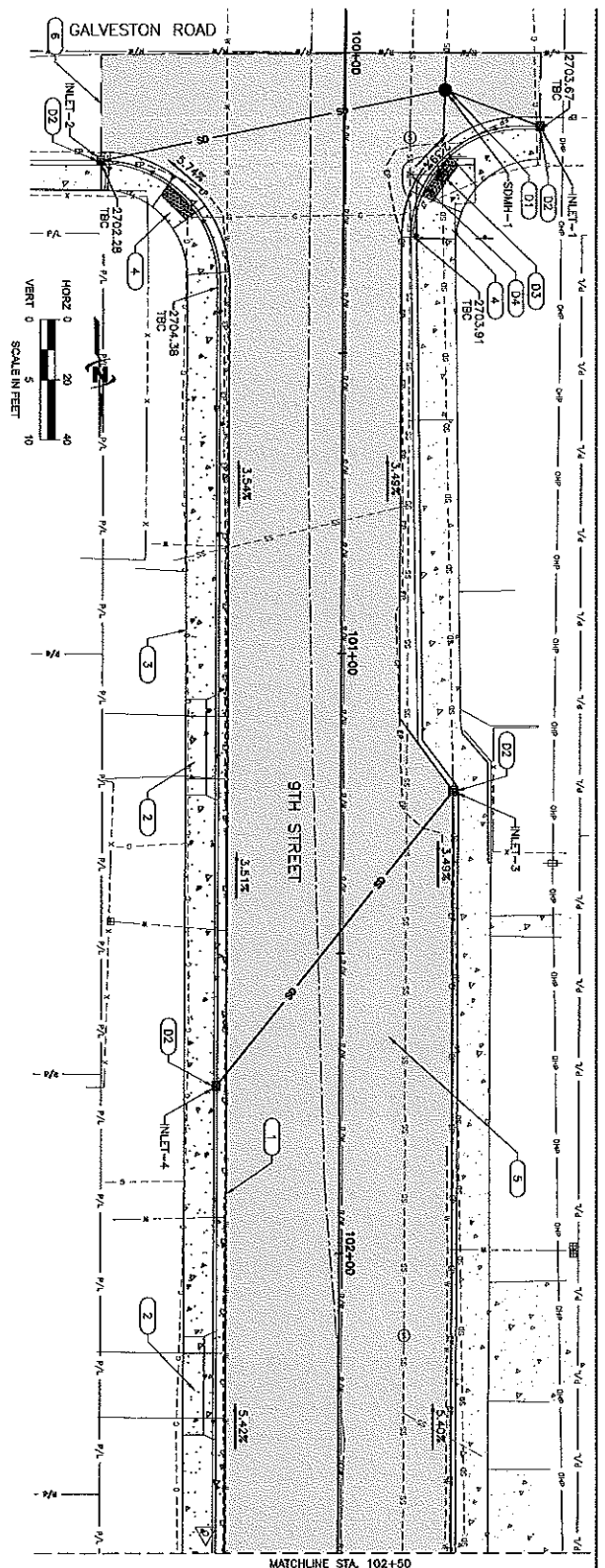

- ROADWAY KEYED NOTES**
- (1) CONST CONCRETE CURBS, CURE AND GUTTER, 214 LF (FOR DETAILS, SEE ODOT STD DWG R0700)
 - (2) CONST CONCRETE SIDEWALK PAVEMENT, 2 EA (FOR DETAILS, SEE ODOT STD DWG R0750)
 - (3) CONST CONCRETE SIDEWALK PAVEMENT, 2 EA (FOR DETAILS, SEE ODOT STD DWG R0750)
 - (4) CONST FULL DEPTH HAAR, 100 LF
 - (5) CONST ASPHALT PAVEMENT SAW CUTTING, 100 LF
- DRAINAGE KEYED NOTES**
- (A) CONST CONCRETE STORM SEWER MANHOLE, 1 EA (FOR DETAILS, SEE ODOT STD DWG R0335)
 - (B) CONST CONCRETE INLET, 1 EA (FOR DETAILS, SEE ODOT STD DWG R0335)
 - (C) REMOVE AND DISPOSE OF EXISTING STORM SEWER MANHOLE, 1 EA
 - (D) REMOVE AND DISPOSE OF EXISTING CONCRETE INLET, 1 EA

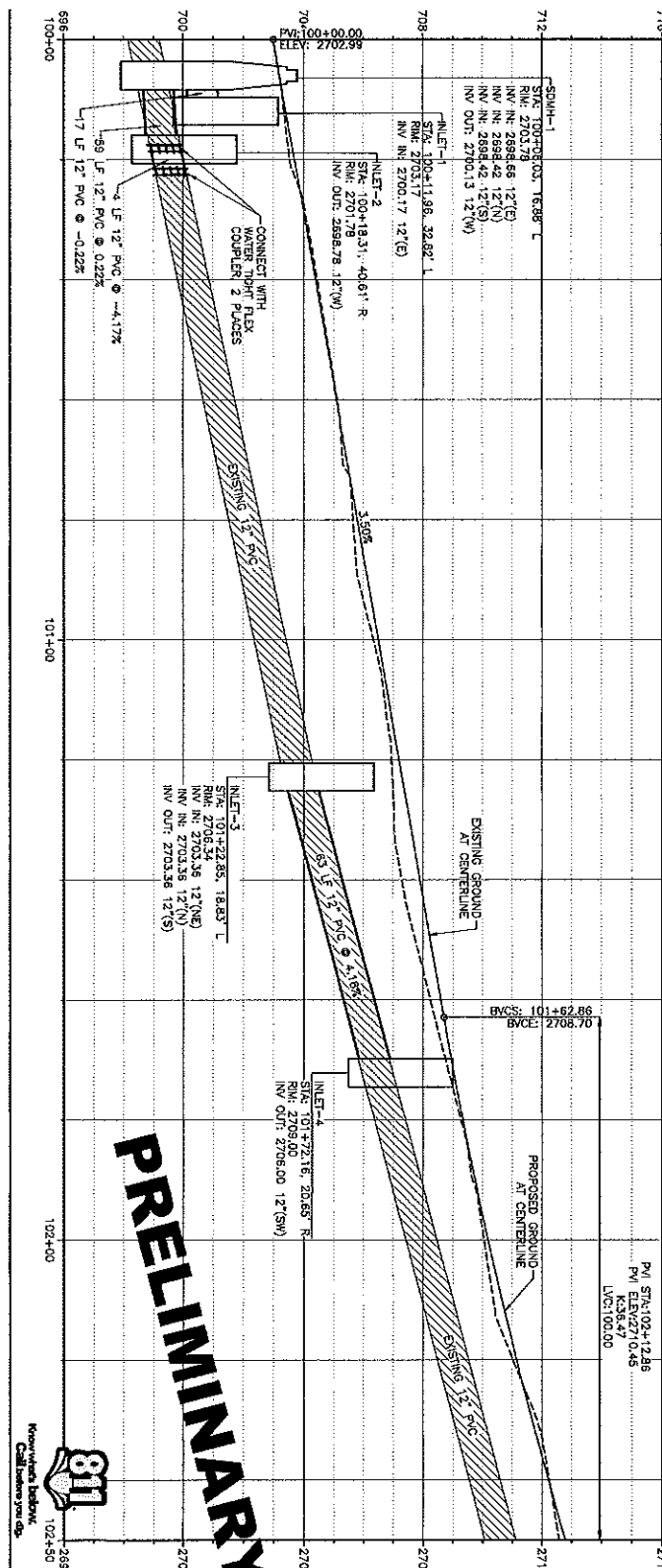

- NOTES**
1. SEE DRAWING DM-101 AND DM-102 FOR DEMOLITION AND RELOCATIONS ARE FOR THIS SHEET ONLY.
 2. SEE DRAWING DM-101 AND DM-102 FOR DEMOLITION AND RELOCATIONS ARE FOR THIS SHEET ONLY.
- LEGEND**
- PROPOSED HOT MIX ASPHALT PAVEMENT (HWAP)
 - EXISTING CONCRETE
 - PROPOSED CONCRETE

<p>811 Know what's below. Call before you dig. 102+50 26986</p>	<p>9TH ST. IMPROVEMENTS: HARTFORD TO GALVESTON RD CITY OF ELGIN</p> <p>DRAINAGE AND GRADING PLAN AND PROFILE</p>	<p>PRELIMINARY PLANS</p> <p>NOT FOR CONSTRUCTION</p>	<p>J-U-B ENGINEERS, INC. 1201 Adams Avenue La Grande, OR 97850 Phone: 541.963.7100 www.jub.com</p>
--	--	--	---